



Quadrant Estate Agents

£475,000



30, Browning Drive

Bicester, OX26 2XN

A rarely available three bedroom link-detached bungalow on the sought after Kings Meadow development close to local shops, veterinary practice and bus route to Bicester town centre. The property briefly comprises entrance vestibule, dining room, lounge, conservatory, kitchen/breakfast room, three double bedrooms, separate w/c, refitted shower room, gas to radiator heating. The property sits on a very spacious plot with private driveway leading to a generous size single garage, gated side access leading to an enclosed private rear garden with summer house. The property is available with NO ONWARD CHAIN. Viewings available from Saturday 5th August.

www.quadrant-estates.co.uk

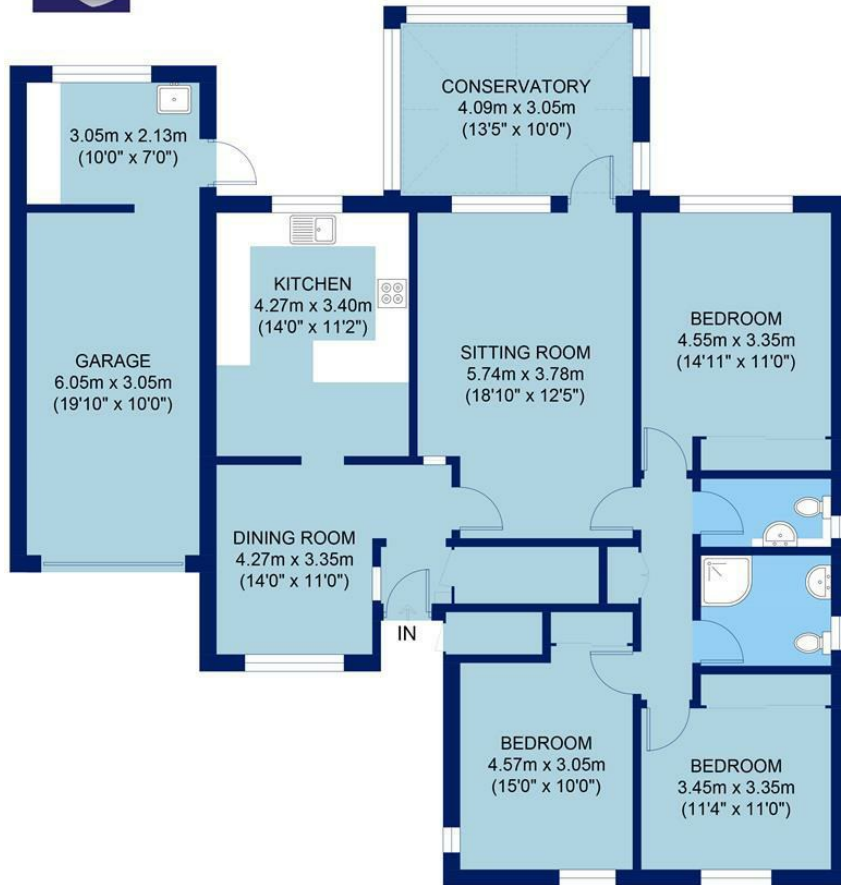

GROUND FLOOR

APPROX. GROSS INTERNAL FLOOR AREA 1,611 SQ FT / 149.7 SQ M
(INCLUDING GARAGE)
30 BROWNING DRIVE

All measurements of walls, doors, windows and fitting and appliances, including their size and location, are shown as standard sizes and therefore cannot be regarded as a representation by the seller.

ACCOMMODATION

- Rarely Available
- Link Detached
- Gas to radiator heating
- Lounge
- Dining room
- Kitchen / Breakfast room
- Conservatory
- Large plot
- Single Garage
- Three Double Bedrooms



Quadrant Estate Agents

10Market Square, Bicester, Oxfordshire, OX26 6AD

t 01869 241166

sales@quadrant-estates.co.uk

www.quadrant-estates.co.uk

IMPORTANT: we would like to inform prospective purchasers that these sales particulars have been prepared as a general guide only. A detailed survey has not been carried out, nor the services, appliances and fittings tested. Room sizes should not be relied upon for furnishing purposes and are approximate. If floor plans are included, they are for guidance only and illustration purposes only and may not be to scale. If there are any important matters likely to affect your decision to buy, please contact us before viewing the property.